

CS 16 10 U ES

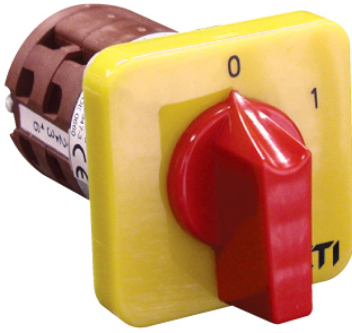

Specificatii

Cod ETI	004773081
Descriere	CS 16 10 U ES
Denumire clasă	Comutator camera
Număr de poli	3
Montare	Panou
Tensiunea maxima de operare (V AC)	400
Tensiune nominala de izolare (V)	690
Curent termic I _{th} (A)	16
Curent nominal operational la AC-21 at 400V (A)	16

[Pagina de produse online](#) 

Alta documentatie



[Catalog caracteristici tehnice](#)

[Model 3D](#)

[Manual de instructiuni](#)

[Declaratie CE](#)

[Eplan mușchi](#)

ETIM clasificare internationala

Clasificare	EC001105
Denumire clasă	Off-load switch
Model	On/Off switch
Number of poles	3
With zero (off) position	1
Rated permanent current I _u	16A
Rated operation power at AC-3, 400 V	7,5kW
Suitable for front mounting	1
Suitable for distribution board installation	1
Type of control element	Turn button
Type of electrical connection of main circuit	Screw connection

Desen cotat

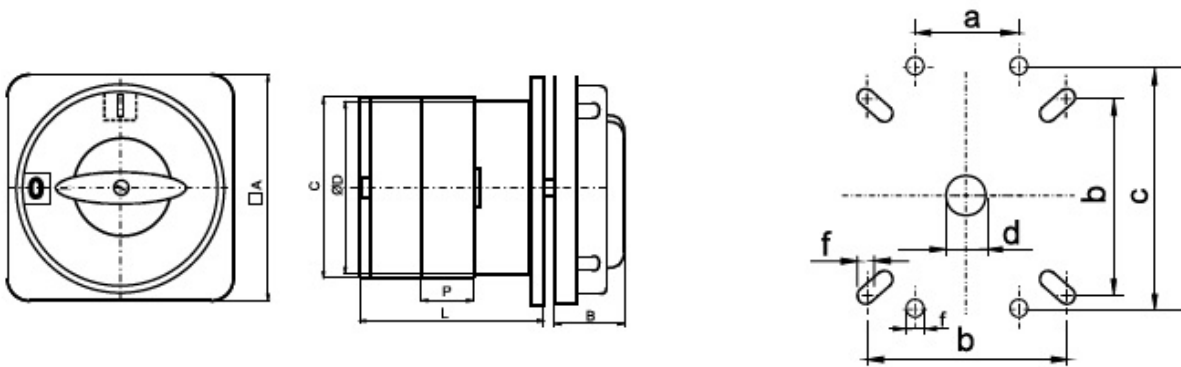

/(mm)	$\square A$	C	$\varnothing D$	P	B	L/2	b	d	f	a	c
CS 25 LK	49	45,2	38,6	12,8	35	45,3	36	10	3,2		
CS 32 LK	72	53	38,6	12,8	32	49,8	58	10	4,2		
CS 40 LK	72	61	56,4	17,5	32	68,1	58	10	4,2		
CS 50 LK	72	68,6	56,4	20,5	32	63	58	10	4,2		
CS 63 LK											
CS 80 LK	105	84	80	25	44	92,5	85	14	5,3		
CS 100 LK											
CS 125 LK	130		110	39	62	100		18	5,3	30	90
CS 200 LK											