

## CS 80 91 U LK



### Specificatii

|   |                  |
|---|------------------|
| Cod ETI   | 004773066        |
| Descriere                                       | CS 80 91 U LK    |
| Denumire clasă                                  | Comutator camera |
| Număr de poli                                   | 2                |
| Montare   | Panou            |
| Tensiunea maxima de operare (V AC)              | 480              |
| Tensiune nominala de izolare (V)                | 690              |
| Curent termic Ith (A)                           | 80               |
| Curent nominal operational la AC-21 at 400V (A) | 80               |

[Pagina de produse online](#) 

### Alta documentatie



[Catalog caracteristici tehnice](#)

[Model 3D](#)

[Manual de instructiuni](#)

[Declaratie CE](#)

[Eplan mușchi](#)

## ETIM clasificare internationala

|   |                  |
|---|------------------|
| Clasificare                                   | EC001105         |
| Denumire clasă                                | Off-load switch  |
| Model   | On/Off switch    |
| Number of poles                               | 2                |
| With zero (off) position                      | 1                |
| Rated permanent current I <sub>u</sub>        | 80A              |
| Rated operation power at AC-3, 400 V          | 32kW             |
| Suitable for front mounting                   | 1                |
| Suitable for distribution board installation  | 1                |
| Type of control element                       | Turn button      |
| Type of electrical connection of main circuit | Screw connection |

## Desen cotat

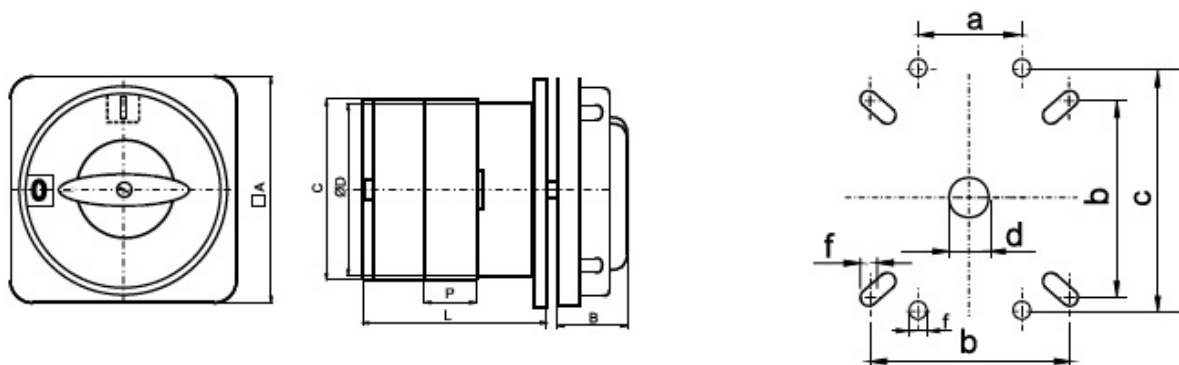

| /(mm)     | $\square A$ | C    | $\emptyset D$ | P    | B  | L/2  | b  | d  | f   | a  | c  |
|-----------|-------------|------|---------------|------|----|------|----|----|-----|----|----|
| CS 25 LK  | 49          | 45,2 | 38,6          | 12,8 | 35 | 45,3 | 36 | 10 | 3,2 |    |    |
| CS 32 LK  | 72          | 53   | 38,6          | 12,8 | 32 | 49,8 | 58 | 10 | 4,2 |    |    |
| CS 40 LK  | 72          | 61   | 56,4          | 17,5 | 32 | 68,1 | 58 | 10 | 4,2 |    |    |
| CS 50 LK  | 72          | 68,6 | 56,4          | 20,5 | 32 | 63   | 58 | 10 | 4,2 |    |    |
| CS 63 LK  |             |      |               |      |    |      |    |    |     |    |    |
| CS 80 LK  | 105         | 84   | 80            | 25   | 44 | 92,5 | 85 | 14 | 5,3 |    |    |
| CS 100 LK |             |      |               |      |    |      |    |    |     |    |    |
| CS 125 LK | 130         |      | 110           | 39   | 62 | 100  |    | 18 | 5,3 | 30 | 90 |
| CS 200 LK |             |      |               |      |    |      |    |    |     |    |    |