

# CEM180.22-24V-50/60Hz



## Specificatii

Cod ETI	004655140
Descriere	CEM180.22-24V-50/60Hz
Denumire clasă	Contactorul motorului
Func ie	Contactor pentru motoare
I (AC1) (A)	225
I (AC3 400V) (A)	180
P (AC3 kW) (kW)	90
Număr de contacte auxiliare NC	2
Număr de poli	3
Tensiunea nominala (V AC)	1000
Tensiunea de control Uc (V AC)	24
Tensiunea de control Uc (V DC)	24

Pagina de produse online [🔗](#)

## Alta documentatie



Catalog caracteristici tehnice

Model 3D

Manual de instructiuni

Declaratie CE

Eplan mușchi

## ETIM clasificare internațională

Clasificare	EC000066
Denumire clasă	Power contactor, AC switching
Rated control supply voltage AC 50 Hz	24...24V
Rated control supply voltage AC 60 Hz	24...24V
Rated control supply voltage DC	24...24V
Voltage type for actuating	AC
Rated operation current I <sub>e</sub> at AC-1, 400 V	225A
Rated operation current I <sub>e</sub> at AC-3, 400 V	180A
Rated operation power at AC-3, 400 V	90kW
Modular version	
Number of auxiliary contacts as normally open contact	2
Number of auxiliary contacts as normally closed contact	2
Type of electrical connection of main circuit	Rail connection
Number of normally open contacts as main contact	3

# Desen cotat

## CEM180(E)

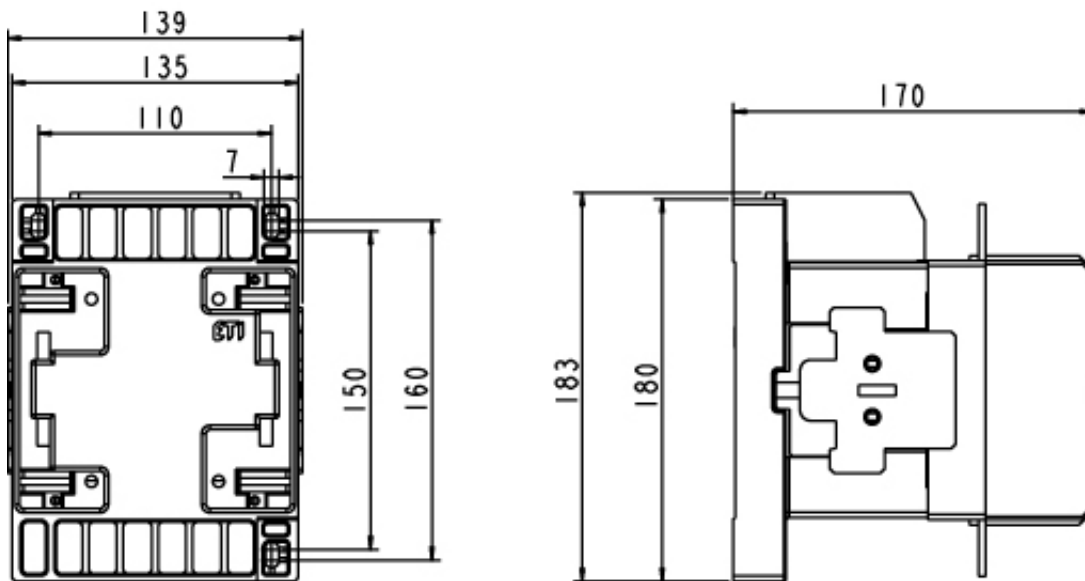

## Schema de conexiuni

