

# CEM180E.22-130V-AC/DC



## Specificatii

Cod ETI	004646026
Descriere	CEM180E.22-130V-AC/DC
Denumire clasă	Contactorul motorului
Func ie	Contactor pentru motoare
I (AC1) (A)	225
I (AC3 400V) (A)	180
P (AC3 kW) (kW)	90
Număr de contacte auxiliare NC	2
Număr de poli	3
Tensiunea nominala (V AC)	1000
Tensiunea de control Uc (V AC)	130
Tensiunea de control Uc (V DC)	130

Pagina de produse online [🔗](#)

## Alta documentatie



Catalog caracteristici tehnice

Model 3D

Manual de instructiuni

Declaratie CE

Eplan mușchi

## ETIM clasificare internationala

Clasificare	EC000066
Denumire clasă	Power contactor, AC switching
Rated control supply voltage AC 50 Hz	110...130V
Rated control supply voltage DC	130...130V
Voltage type for actuating	AC/DC
Rated operation current I <sub>e</sub> at AC-1, 400 V	225A
Rated operation current I <sub>e</sub> at AC-3, 400 V	180A
Rated operation power at AC-3, 400 V	90kW
Modular version	
Number of auxiliary contacts as normally open contact	2
Number of auxiliary contacts as normally closed contact	2
Type of electrical connection of main circuit	Rail connection
Number of normally open contacts as main contact	3

# Desen cotat

## CEM180(E)

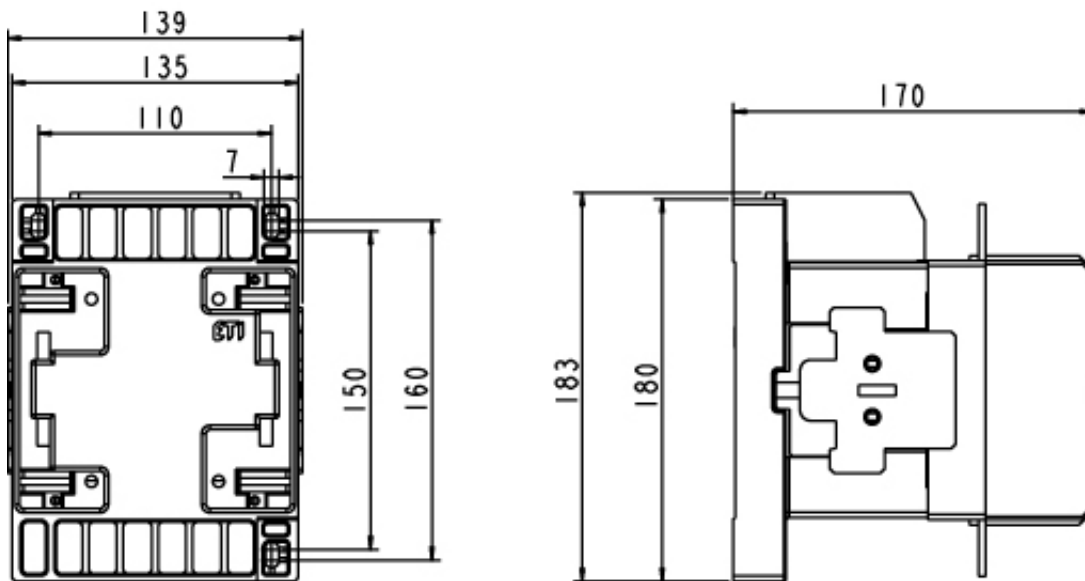

## Schema de conexiuni

