

# EP 3232



## Specificatii

|                       |                   |
|-----------------------|-------------------|
| Cod ETI               | 004482061         |
| Descriere             | EP 3232           |
| Denumire clasă        | CEE ștecher       |
| Curent nominal (A)    | 32                |
| Tensiunea nominală(V) | 230               |
| Număr de poli         | 2+PE              |
| Grad de protecție IP  | IP44              |
| Tip priză             | Ștecher de perete |

[Pagina de produse online](#) 

## Alta documentatie



[Catalog caracteristici tehnice](#)

[Declaratie CE](#)

[Eplan mușchi](#)

## ETIM clasificare internationala

|                                 |   |
|---------------------------------|---|
| Clasificare                     | EC001319  |
| Denumire clasă                  | CEE plug for mounting on machines and equipment |
| IEC-amperage                    | 32A   |
| Voltage according to EN 60309-2 | 230 V (50+60 Hz) blue                           |
| Number of poles                 | 2   |
| Clock hour position             | 6h  |
| Identification colour           | Blue  |
| Degree of protection (IP)       | IP44  |
| Connection system               | Screwed terminal                                |
| Construction type               | Built-up device plug                            |
| Insert direction                | Straight  |
| Material                        | Plastic   |

## Desen cotat

|          | A   | B  | C  | ød1 | E1 | E2 | F  |
|----------|-----|----|----|-----|----|----|----|
| EP 1632  | 147 | 81 | 78 | 4   | 30 | 53 | 58 |
| EP 1643  | 146 | 81 | 78 | 4   | 30 | 53 | 58 |
| EP 1653  | 146 | 81 | 78 | 4   | 30 | 53 | 58 |
| EP 3243  | 168 | 95 | 88 | 4   | 35 | 61 | 60 |
| EP 3253  | 168 | 95 | 88 | 4   | 35 | 61 | 60 |
| EPO 1653 | 146 | 81 | 78 | 4   | 30 | 53 | 58 |
| EPO 3253 | 168 | 95 | 88 | 4   | 35 | 61 | 60 |

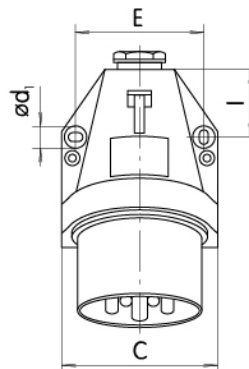
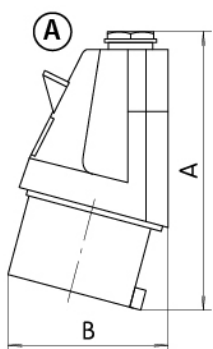
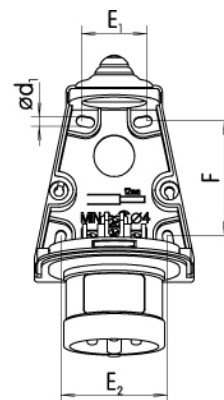
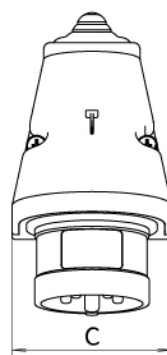
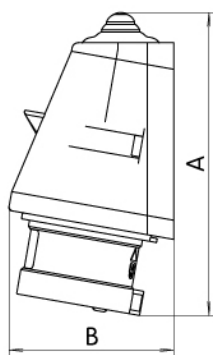

|         | A   | B   | C  | ød1 | E  | I  | Pg  | Modification |
|---------|-----|-----|----|-----|----|----|-----|--------------|
| EP 3232 | 147 | 105 | 82 | 5,2 | 67 | 34 | P21 | A            |