

EP 1632



Specificatii

Cod ETI	004482058
Descriere	EP 1632
Denumire clasă	CEE ștecher
Curent nominal (A)	16
Tensiunea nominală(V)	230
Număr de poli	2+PE
Grad de protecție IP	IP44
Tip priză	Ștecher de perete

[Pagina de produse online](#) 

Alta documentatie



[Catalog caracteristici tehnice](#)

[Declaratie CE](#)

[Eplan mușchi](#)

ETIM clasificare internationala

Clasificare	EC001319
Denumire clasă	CEE plug for mounting on machines and equipment
IEC-amperage	16A
Voltage according to EN 60309-2	230 V (50+60 Hz) blue
Number of poles	2
Clock hour position	6h
Identification colour	Blue
Degree of protection (IP)	IP44
Connection system	Screwed terminal
Construction type	Built-up device plug
Insert direction	Straight
Material	Plastic

Desen cotat

	A	B	C	ød1	E1	E2	F
EP 1632	147	81	78	4	30	53	58
EP 1643	146	81	78	4	30	53	58
EP 1653	146	81	78	4	30	53	58
EP 3243	168	95	88	4	35	61	60
EP 3253	168	95	88	4	35	61	60
EPO 1653	146	81	78	4	30	53	58
EPO 3253	168	95	88	4	35	61	60

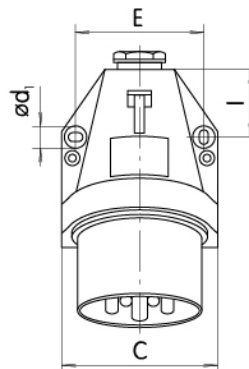
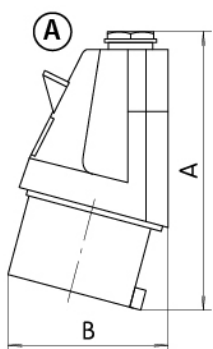
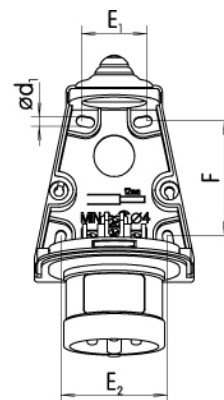
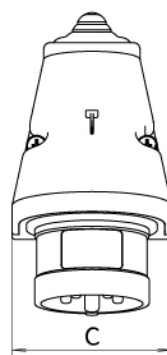
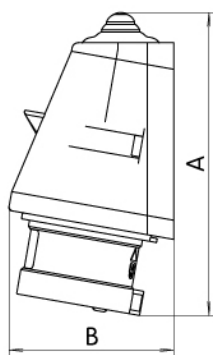

	A	B	C	ød1	E	I	Pg	Modification
EP 3232	147	105	82	5,2	67	34	P21	A