

## NH0 aM 20A/690V



### Specificatii

|                                 |                                                                                |
|---------------------------------|--------------------------------------------------------------------------------|
| Cod ETI                         | 004112126                                                                      |
| Descriere                       | NH0 aM 20A/690V                                                                |
| Denumire clasă                  | Siguranță                                                                      |
| Curent nominal (A)              | 20                                                                             |
| Tip                             | NH                                                                             |
| Mărime                          | NH0                                                                            |
| Caracteristici                  | aM                                                                             |
| Tensiune nominală AC (V)        | 690                                                                            |
| Indicator                       | Indicator principal al siguranței                                              |
| Capacitatea de rupere (AC) (kA) | 100                                                                            |
| Putere disipată (W)             | 1,3                                                                            |
| Standarde                       | VDE 0636-2011                                                                  |
| Operare Joule integrală (A2s)   | 8.900                                                                          |
| Curentul de pre-arc (A2s)       | 1.140                                                                          |
| Aplicație                       | Pentru protecția releelor, contactoarelor și motoarelor în caz de scurtcircuit |

Pagina de produse online

### Alta documentatie



Catalog caracteristici tehnice

Certificate

Model 3D

Manual de instrucțiuni

Declaratie CE

Eplan mușchi

## ETIM clasificare internationala

|                                      |                            |
|--------------------------------------|----------------------------|
| Clasificare                          | EC000055                   |
| Denumire clasă                       | Low Voltage HRC fuse       |
| Construction size                    | NH0                        |
| Rated current                        | 20                         |
| Rated voltage                        | 690                        |
| Voltage type                         | AC                         |
| Rated switching capacity             | 100                        |
| Utilization category                 | aM (switchgear protection) |
| Type of fuse status indicator        | Top fuse status indicator  |
| Insulated metal gripping lugs (IMGL) |                            |

# Caracteristicile energiei de topire

Cut-off current characteristics

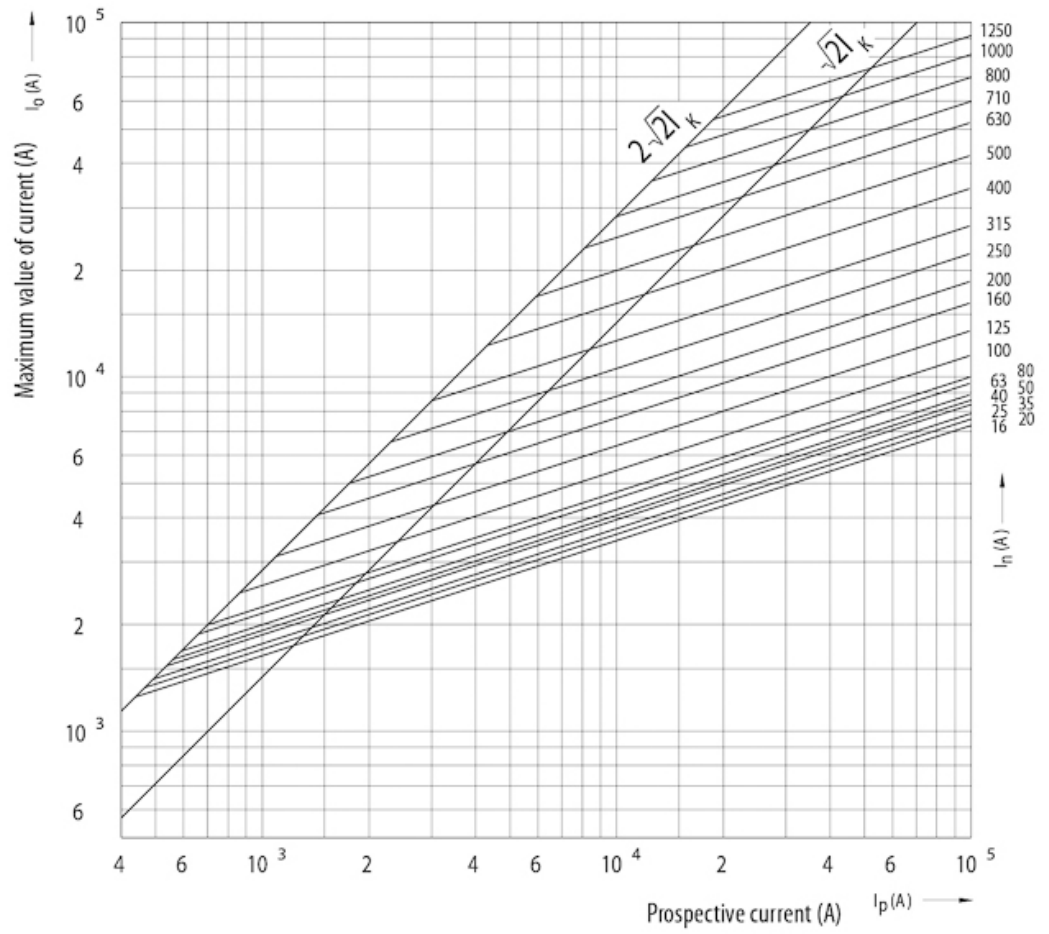

# Desen cotat

|           | A   | B  | C  | D  | E  | F   | G   | H   | I   | J  | K |       |
|-----------|-----|----|----|----|----|-----|-----|-----|-----|----|---|-------|
| NV00C     | 79  | 53 | 47 | 35 | 15 | 21  | 52  | 7,5 |     |    | 6 | kombi |
| NV00C I   | 79  | 53 | 47 | 35 | 15 | 21  | 52  | 7,5 |     |    | 6 | kombi |
| NV00      | 79  | 53 | 47 | 35 | 15 | 28  | 56  | 12  |     |    | 6 | kombi |
| NV00 I    | 79  | 53 | 47 | 35 | 15 | 28  | 56  | 12  |     |    | 6 | kombi |
| NV0       | 125 | 68 | 65 | 35 | 15 | 28  | 56  | 12  |     |    | 6 | kombi |
| NV1C      | 135 | 68 | 65 | 40 | 15 | 28  | 61  | 12  |     |    | 6 | kombi |
| NV1C I    | 135 | 68 | 65 | 40 | 15 | 28  | 61  | 12  |     |    | 6 | kombi |
| NV1       | 135 | 72 | 65 | 40 | 20 | 46  | 65  | 14  |     |    | 6 | kombi |
| NV1 I     | 135 | 72 | 65 | 40 | 20 | 46  | 65  | 14  |     |    | 6 | kombi |
| NV2C      | 150 | 72 | 65 | 48 | 20 | 46  | 73  | 14  |     |    | 6 | kombi |
| NV2C I    | 150 | 72 | 65 | 48 | 20 | 46  | 73  | 14  |     |    | 6 | kombi |
| NV2       | 150 | 72 | 65 | 48 | 26 | 54  | 73  | 14  |     |    | 6 | kombi |
| NV2 I     | 150 | 72 | 65 | 48 | 26 | 54  | 73  | 14  |     |    | 6 | kombi |
| NV3C      | 150 | 72 | 65 | 60 | 26 | 54  | 84  | 14  |     |    | 6 | kombi |
| NV3       | 150 | 72 | 65 | 60 | 33 | 65  | 84  | 14  |     |    | 6 | kombi |
| NV4       | 200 | 75 | 66 | 87 | 50 | 100 | 121 | 24  | 150 | 16 | 8 |       |
| NV4a      | 200 | 99 | 87 | 85 | 50 | 95  | 121 | 27  |     |    | 6 |       |
| NV4a SI*  | 200 | 99 | 87 | 85 | 50 | 95  | 121 | 27  |     |    | 6 |       |
| NV1/1000V | 155 | 90 | 87 | 40 | 20 | 45  | 59  | 9   |     |    | 6 |       |

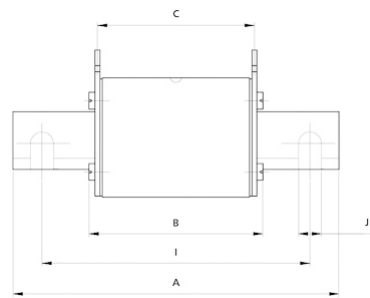

|     | Striker pin |      |      |     |
|-----|-------------|------|------|-----|
|     | K           | L    | M    | S1  |
| 00C | 0           | 20.7 | 16.7 | 7.5 |
| 00  | 0           | 20.7 | 16.7 | 7.5 |
| 1   | 13.7        | 19.7 | 25   | 12  |
| 2   | 16.2        | 27.4 | 25   | 12  |
| 3   | 17          | 35.6 | 25   | 12  |
| 4a  | 24          | 49   | 25   | 12  |

