

## SV 4100 4p 100A



### Specificatii

Cod ETI	002423416
Descriere	SV 4100 4p 100A
Denumire clasă	Comutator integrat
Func ie	Comutatoare de sarcină
Curent nominal (A)	100

Pagina de produse online 

### Alta documentatie



Catalog caracteristici tehnice

Model 3D

Declaratie CE

Eplan mușchi

## ETIM clasificare internațională

Clasificare	EC000216
Denumire clasă	Switch disconnector
Version as main switch	1
Version as maintenance-/service switch	1
Version as safety switch	1
Version as emergency stop installation	1
Max. rated operation voltage Ue AC	400V
Rated permanent current Iu	100A
Conditioned rated short-circuit current Iq	4kA
Number of poles	4
Motor drive optional	
Motor drive integrated	
Device construction	Built-in device fixed built-in technique
Suitable for distribution board installation	1
Type of control element	Rocker lever
Interlockable	
Type of electrical connection of main circuit	Frame clamp
Degree of protection (IP), front side	IP20

## Desen cotat

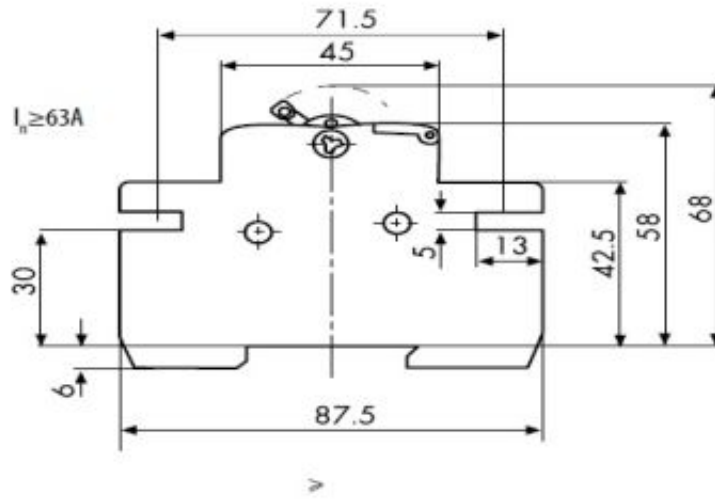

## Simbol/Conexiune



**2**

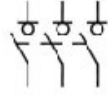

**3**

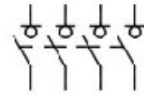

**4**