

SV 116 1p 16A



Specificatii

| | |
|--------------------|------------------------|
| Cod ETI | 002423121 |
| Descriere | SV 116 1p 16A |
| Denumire clasă | Comutator integrat |
| Funcție | Comutatoare de sarcină |
| Curent nominal (A) | 16 |

[Pagina de produse online](#) 

Alta documentatie



[Catalog caracteristici tehnice](#)

[CertIFICATE](#)

[Model 3D](#)

[Declaratie CE](#)

[Eplan mușchi](#)

ETIM clasificare internațională

| | |
|---|--|
| Clasificare | EC000216 |
| Denumire clasă | Switch disconnector |
| Version as main switch | 1 |
| Version as maintenance-/service switch | 1 |
| Version as safety switch | 1 |
| Version as emergency stop installation | 1 |
| Max. rated operation voltage Ue AC | 230V |
| Rated permanent current Iu | 16A |
| Conditioned rated short-circuit current Iq | 2kA |
| Number of poles | 1 |
| Motor drive optional | |
| Motor drive integrated | |
| Voltage release optional | 1 |
| Device construction | Built-in device fixed built-in technique |
| Suitable for distribution board installation | 1 |
| Type of control element | Rocker lever |
| Interlockable | |
| Type of electrical connection of main circuit | Frame clamp |
| Degree of protection (IP), front side | IP20 |

Desen cotat

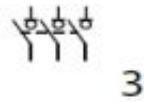
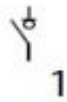
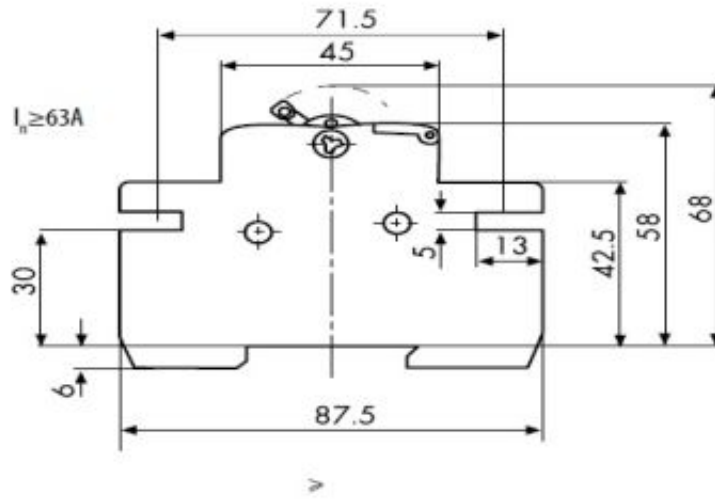

Simbol/Conexiune



2

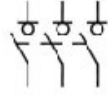

3

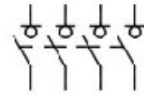

4